

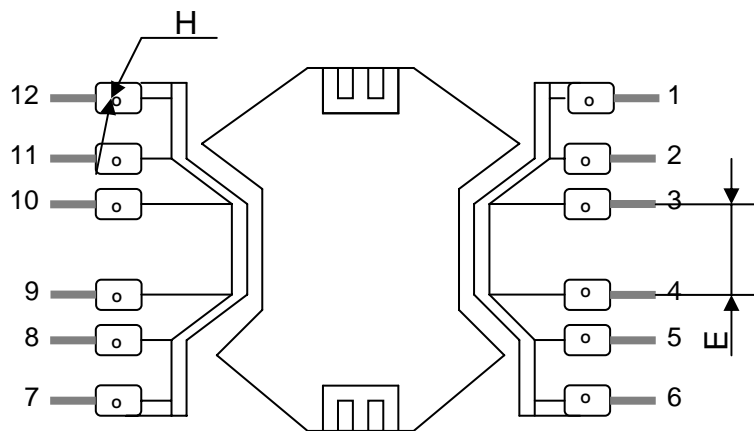

RM 10 - 12 PINOS

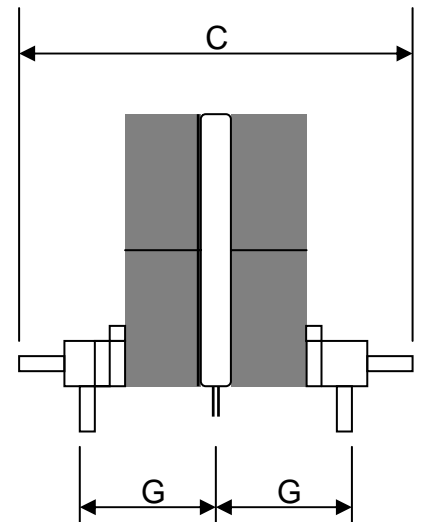
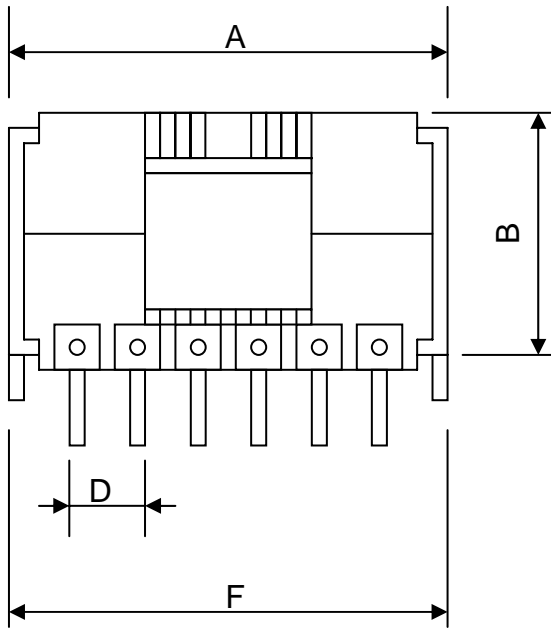

TOLERÂNCIA: +/- 0,5MM

ÁREA ÚTIL DA JANELA: 25,2MM²

CARRETEL	A	B	C	D	E	F	G	H
RM 10 - 12 PINOS	30,0	18,7	40,0	3,8	5,0	29,0	14,0	1,0