

E 28 - 12 pinos

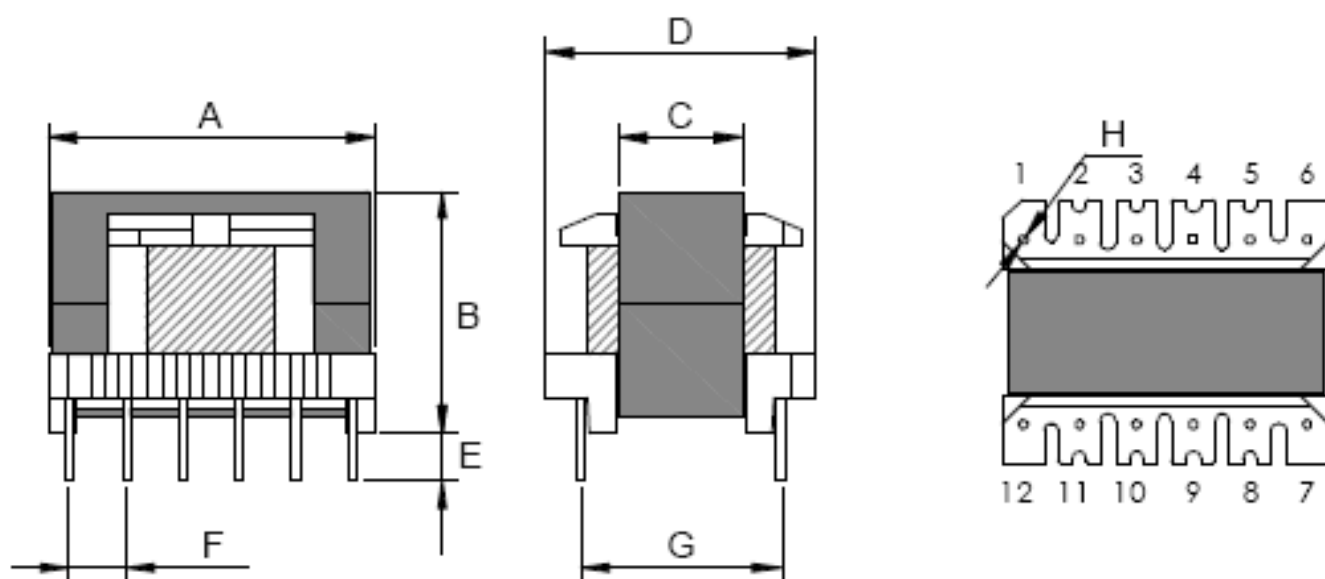

TOLERÂNCIA: $\pm 0,5\text{mm}$.

AL: $2800\text{nH} +30 / -20\%$

ÁREA ÚTIL DA JANELA: $25,5\text{mm}^2$

CARRETEL	A	B	C	D	E	F	G	H
E 28 - 12 pinos	29,0	22,0	11,0	24,0	5,0	5,0	17,5	0,8